

Starlock® Push-On Fasteners Double D Type

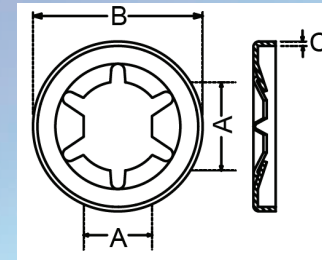

A		B	C
Shaft size	Part No:	Outside Diameter	Material Thickness
.620" (.496A/F)	6930	.985"	.016"



The Double D Starlock® is designed to fit on a round shaft, which has two parallel flats. A popular application is in door handle fittings.

All dimensions shown are subject to engineering tolerances.

These fasteners can be supplied in blue and varnish BV or in mechanical zinc plated DT finishes.

Starlocks® are generally available in spring steel and many supplied in stainless steel.

Non-standard parts may be subject to a minimum order quantity.

Baker & Finnemore Ltd, 199 Newhall Street, Birmingham, B3 1SN, United Kingdom
UK Tel: +44 (0) 121 236 2347 Fax: +44 (0) 121 7224 e-mail: sales@bakfin.com
www.bakfin.com www.starpres.co.uk